

ROOF HUGGER, LLC  
 P.O. BOX 127, ODESSA FL 33556  
 P: 800 771-1711  
 F: 877 202-2254  
 www.roofhugger.com

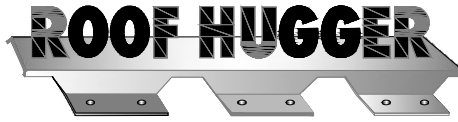

COPYRIGHT © 2017  
 A Member Company of LSI Group, Inc.

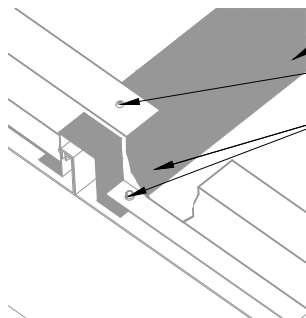

NEW 16 GA SUB RAFTER  
 #10-16 X 1" DP3 PANCAKE

2 EACH 1/4"-14 DP3 FASTENERS AT EACH SIDE OF  
 PANEL RIB INTO SUB-RAFTER AND EXISTING PURLIN .  
 ONLY ONE INSTALLS THROUGH HUGGER AND THE OTHER  
 FROM SUB-RAFTER TO PURLIN ONLY

1/4"-14 DP3 FASTENER AT EACH SIDE OF  
 PANEL RIB INTO SUB-RAFTER

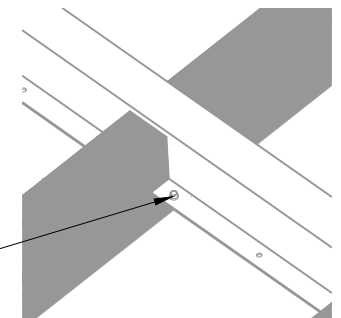

HUGGER OVER PURLIN

HUGGER NOT OVER PURLIN

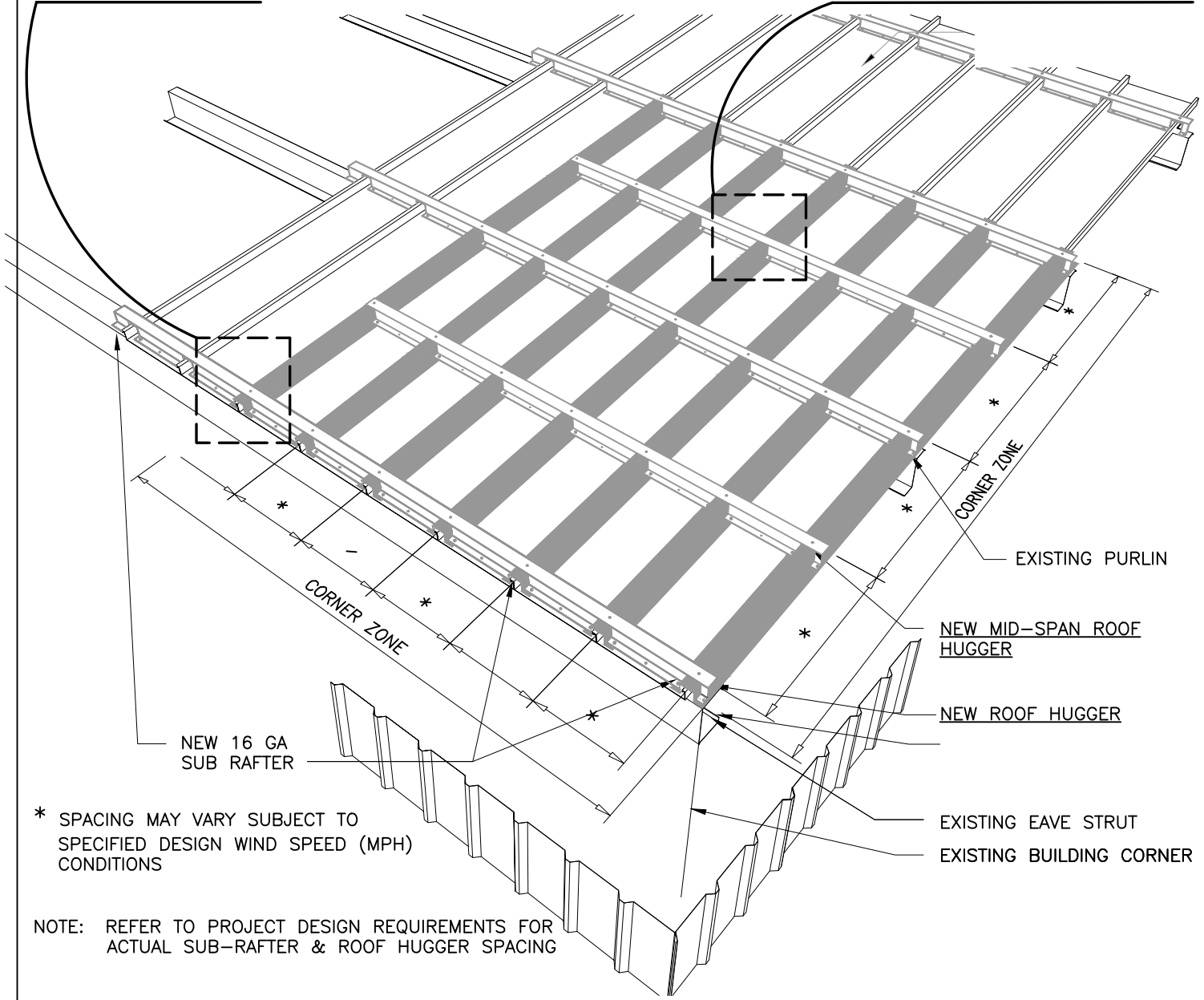

\* SPACING MAY VARY SUBJECT TO  
 SPECIFIED DESIGN WIND SPEED (MPH)  
 CONDITIONS

NOTE: REFER TO PROJECT DESIGN REQUIREMENTS FOR  
 ACTUAL SUB-RAFTER & ROOF HUGGER SPACING

EXISTING VERTICAL RIB SSR PROFILE METAL ROOF

**CORNER/EDGE WIND UPLIFT ZONE FRAMING**

**ZF-03-V**  
 10/15/2013