

ROOF HUGGER, LLC
P.O. BOX 127, ODESSA FL 33556
P: 800 771-1711
F: 877 202-2254
www.roofhugger.com

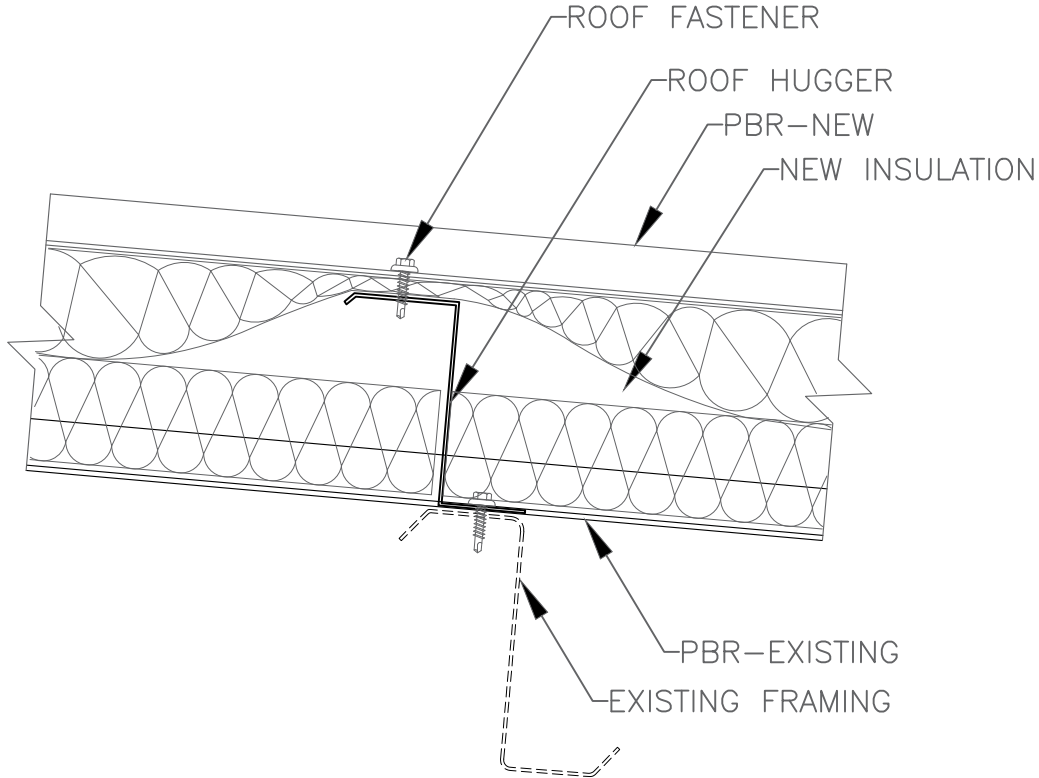

COPYRIGHT © 2019
A Member Company of LSI Group, Inc.



PBR OVER PBR
DOUBLE BLANKET

System	PBR over PBR - Double Blanket					
Roof Hugger Web Depth in Inches	Maximum Cavity Depth in Inches	Initial Insulation Thickness in Inches	Estimated R-Value	Estimated U-Value	Thermal Spacer Thickness in Inches	UNFACED Blanket Thickness Combination Used
3.75	4.000	5.50	12.94	0.077	n/a	2.75" blanket over purlins; 1/4" used as max. compression; 2.75" blanket between purlins
4.50	4.750	5.50	13.78	0.073	n/a	2.75" blanket over purlins; 1/4" used as max. compression; 2.75" blanket between purlins

Compressed insulation R-Values have been calculated from a published method of the North American Insulation Manufacturers Association™ (NAIMA™).

Insulation R-Value calculated based on published industry information from NAIMA™, CertainTeed®, Johns Manville® or Owens Corning®.

Due to variations in installation methods and metal roof rib or seam configurations; calculated values shown here in do not compensate for thermal bridging or thermal loss from existing roof panel rib configuration.

Calculated R-Values shown herein do not take credit for air film effects or use of vapor barriers within the insulation system.

INSULATED ASSEMBLIES
DOUBLE BLANKET
PBR OVER PBR

SCALE: NTS

02-2B-R-R
07/15/2019